

Andrii Bukharin

Astrocartography

Study guide

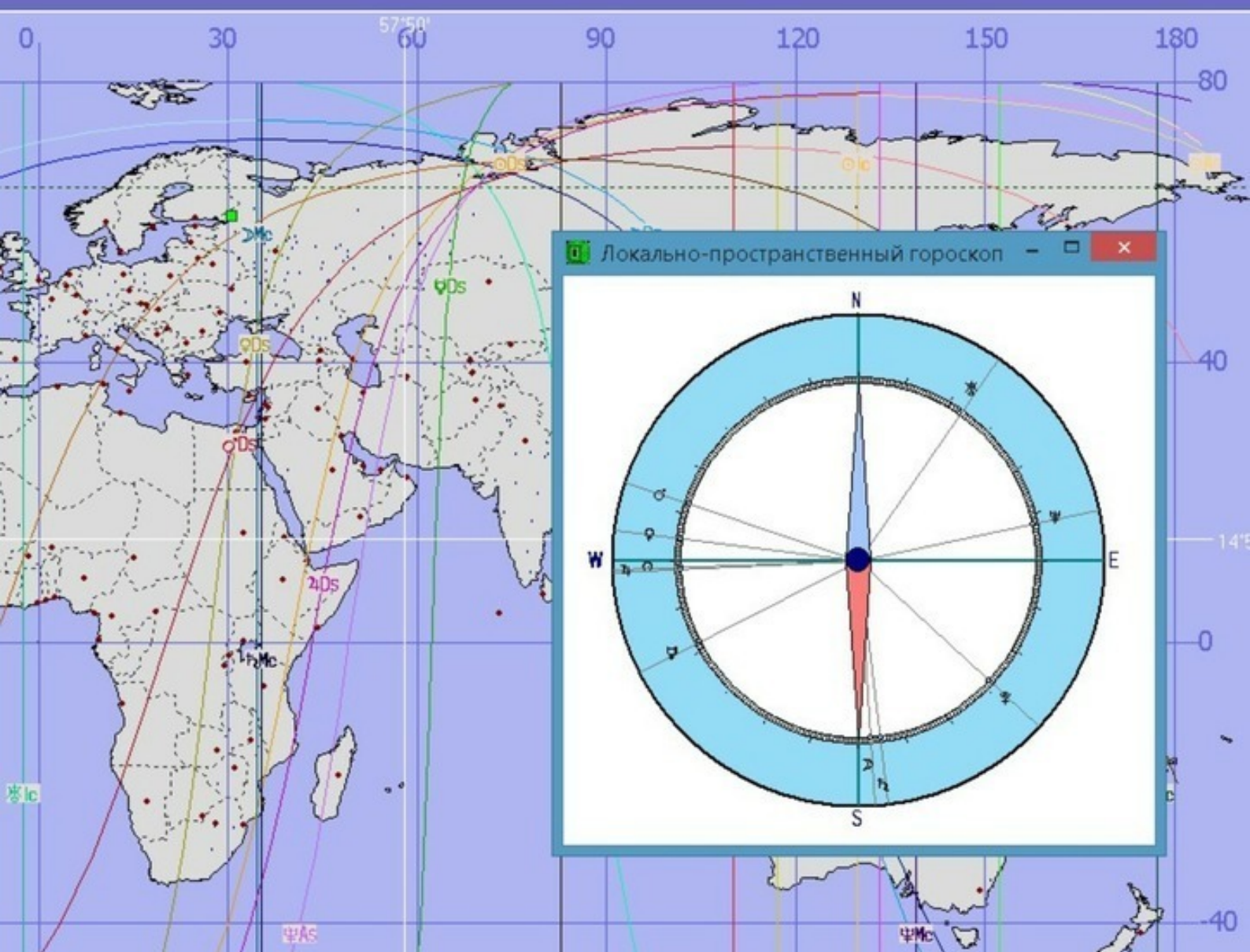

Andrii Bukharin

Astrocartography. Study guide

«Издательские решения»

Bukharin A.

Astrocartography. Study guide / A. Bukharin — «Издательские решения»,

ISBN 978-5-44-830583-2

The book is focused on students of senior astrologic courses and practicing astrologers, as additional material to the lectures on Astrocartography. The material is presented clearly, specifically, at a word and is based on: «brevity is the soul of wit». Widerange of samples from practice.

ISBN 978-5-44-830583-2

© Bukharin A.
© Издательские решения

Содержание

Astrocartography	6
Introduction	7
Preface	8
Historical notes	9
Prior to work with ACG	10
Astrocartography	11
Local Space	12
Technical calculation	13
Interpretation	15
Application	16
Descriptions of planetary lines of ls	21
Samples of ls	23
Astrogeography	24
Technical calculation	24
Interpretation	30
The planets in the houses of horoscope	31
Moon	32
Конец ознакомительного фрагмента.	35

Astrocartography

Study guide

Andrii Bukharin

© Andrii Bukharin, 2016

ISBN 978-5-4483-0583-2

Created with intellectual publishing system Ridero

Astrocartography

Study guide

The book is focused on students of senior astrologic courses and practicing astrologers, as additional material to the lectures on Astrocartography. The material is presented clearly, specifically, at a word and is based on: «brevity is the soul of wit». Wide range of samples from practice.

Illustrator Pavel Sviridov.

Introduction

The modern world is directed its wings into future with cosmic velocity. New technologies universally and extraordinary fast enter our life. The things, that 10—20 years ago have been considered as fantastic fiction, for now they are routine actuality. The science astrology is not the exception, it is not for the first year, since astrology stepped beyond the frames of medieval dogmata and traditions. The direct proof of this fact is the modern branch of astrology, Astrocartography, hereinafter ACG. ACG is a modern astrological technique, based on projection of celestial bodies on the Earth's surface. With the help of this technique, we can define favorable and unfavorable places for human life. The modern astrologist, who masters the ACG technique, can rise to a new level of its professional skills.

On actual basis, ACG is astrology of XXI century!

Preface

To be going on, I would like to thank my first teachers on ACG technique: Sergey Kurpatov, Pavel Sviridov and David Meadows.

I wish you all health, many happy returns and success in your creative endeavors!

Owing to their lectures and astrological programs, I acquainted with this interesting astrological technique of analysis and prediction. In the pre-computer age, it was impossible to apply this astrological technique. At one of the seminars D.Meadows said, that once he decided to try to make calculations of 10 Planets and 4 angles of the map. It took him 3 days to draw one map! However, if the map is wrong and it should be drawn again? Or, if you should draw more than one map? Dear reader understands, in this case, it is impossible to work without modern computer programs.

We should comprehend that there are no perfect software that is why, in my practice, I use several astrological programs: «VegaSviri Matrix», «Astrogeography V2.7.», ZETGEO 9.0.

My main «workhorse» is the astrological program of Pavel Vladimirovich Sviridov «VegaSviri Matrix». It performs everything quickly and promptly. When I have lack of functional of «VegaSviri Matrix», I use «Astrogeography V2.7.», I use ZET GEO 9.0 for educational purposes, when participants don't have the first two programs.

In this book, with permission of Sviridov P.V., I published texts of ACG description of the Planets.

The main material on Astrocartography subject I give during lectures and seminars on this theme. In this book, I state the additional information, which contributes to a better understanding of this subject.

Historical notes

For the first time the astrological technique of work with geographic maps was applied by American traveler and astrologist Jim Lewis. Back in 1975, when visiting different locations, he noted some regularity. In the same planetary locations, the events, that had happened to him had the same character (positive or negative, depends on his location). Jim Lewis was the inventor of ACG. The widespread of this astrological technique was given by his follower David Meadows, the author of «Where In The World With Astrocartography».

Prior to work with ACG

What you should know and use in ACG.

If in Astropsychology, in particular cases, you can neglect precise rectification, I do not recommend working with ACG technique without precise rectification.

When using the natal chart with inaccurate time of birth, there will be great differences in the predictions.

Astrocartography

It is important to know, that ACG technique consists of three main segments:

Local space, or as we can call it astrological fen-shui.

Planetary radix lines. Projection of local charts on the Earth's ground.

The natal chart (hereinafter NC) – basic part of ACG. How to draw the NC properly is provided on the first courses of all standard astrological schools, consequently I will not speak about it in this book.

Horoscope of the geodesic (geodetic) equivalent. Astrological technique, where the constant is a principal meridian.

At present, in astrological association there is no one frame of mind, which principal meridian should be used as a constant: someone thinks, that it is 0 Greenwich, someone – from Ural Mountains, someone – from Canary Islands and etc.

The fact is that if I do not understand or if I see, that astrological technique is not working, so I will not tell about it during my lectures, moreover I will not write the books about it.

Now I am researching this astrological technique. As soon, as my practice gives the sustainable positive result, I will certainly publish it. So, follow my news, which I regularly post on my official website [битая ссылка] www.rasvetsiriusa.com

Therefore, in this book, I will tell about the first two astrological techniques.

Local Space

(Azimuth lines projection)

Technical calculation

At the time of native's birth, all planets are located around its birth's place in various directions. The projection of celestial position of the planets is executed on the Earth's ground. Moreover, from the native birth's place are drawn the azimuth lines to these projections.

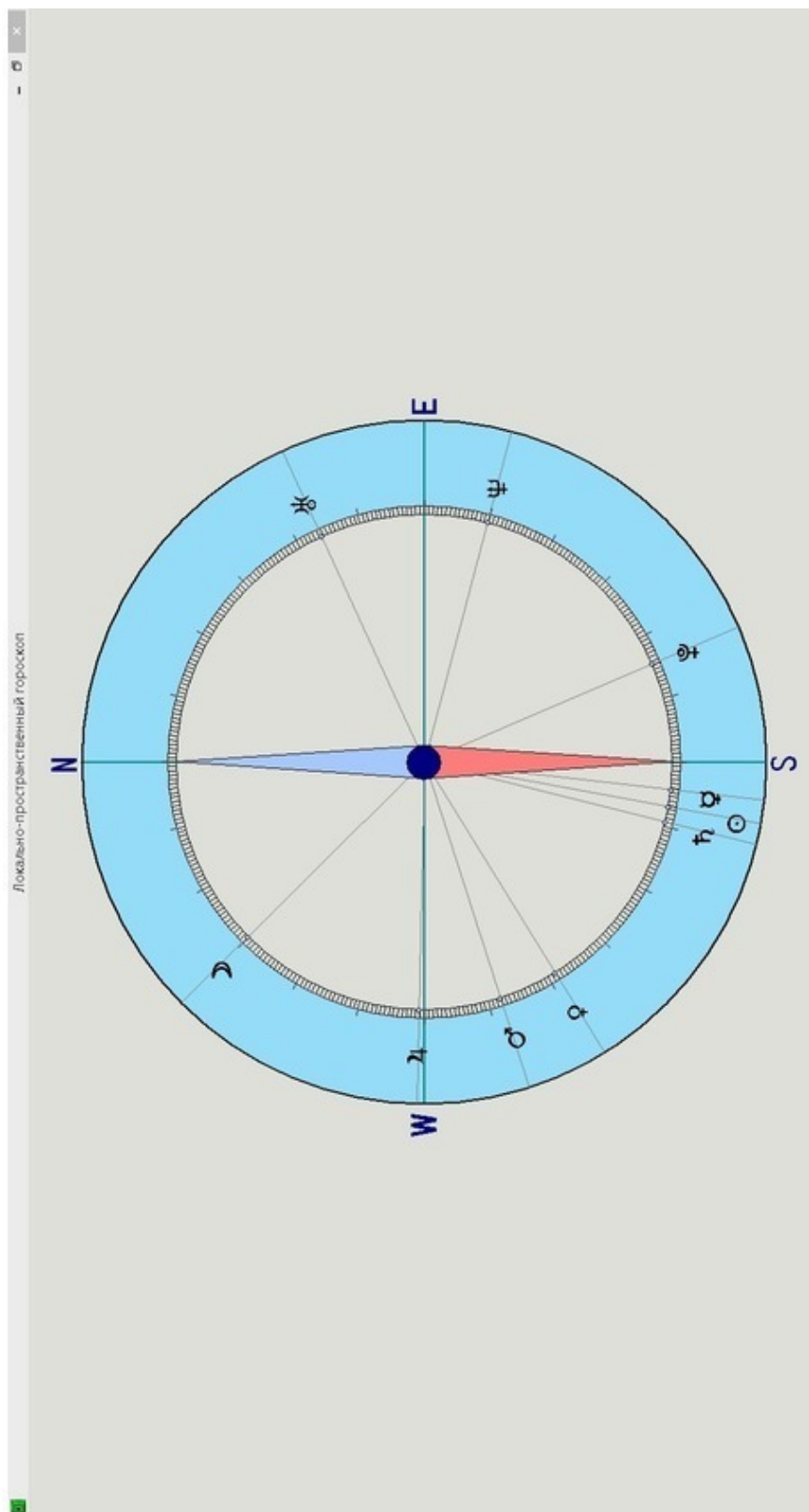

Pic.1. Local Space (hereinafter LS). Astrological program «VegaSviri Matrix».

Interpretation

The most relevant explanation – on the analogy of location of the planets in Zodiacal signs. These locations describe the psychological expectation and attitude of the person, located currently at a certain point. I would express it this way: subconscious motives construct events through the behavior.

Application

As astrological fen-shui in the room, house, flat, town, country, planet, the LS should be targeted in accordance with cardinal points and make its projection on the place, taking into account the locality (change of place of stay, if it happens to be).

According to the characteristics of planetary lines in one junction or another, you can give the client some hints, what he should expect in one place or another. In other words, there might be dangerous places of native's location, favorable and etc., e.g:

The Moon – place of residence.

Mercury – place of education.

Venus – love, romance.

The Sun – creative materialization.

Mars – sports activities.

Jupiter – place of good luck and success, business and etc.

Saturn – territory of loneliness and fear.

Uranus – revolutions, surprises.

Neptune – complicated situations risk from water.

Pluto – risk from the crime.

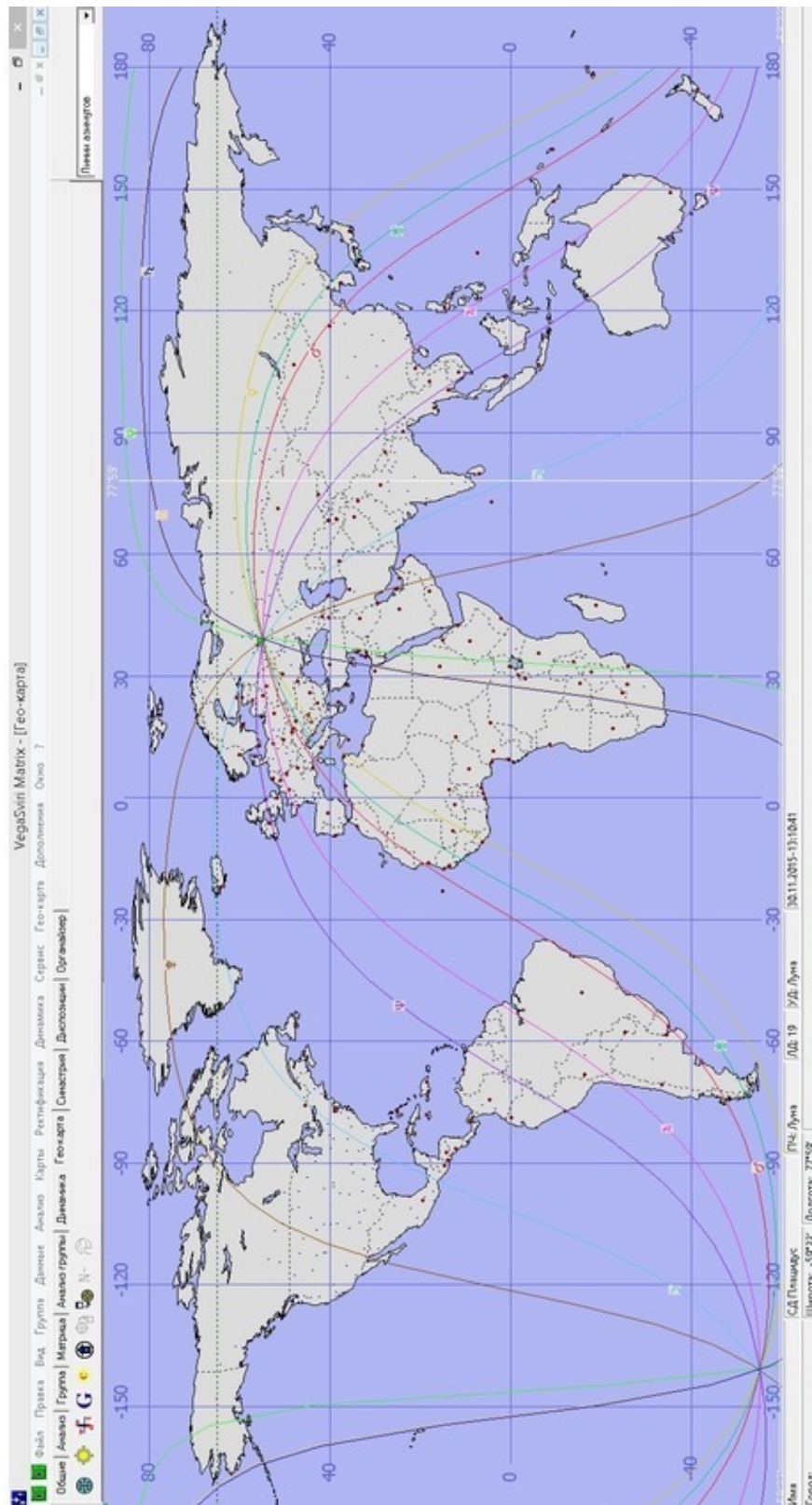

Pic.2. LS on the Earth's entire territory. Astrological program «VegaSviri Matrix»

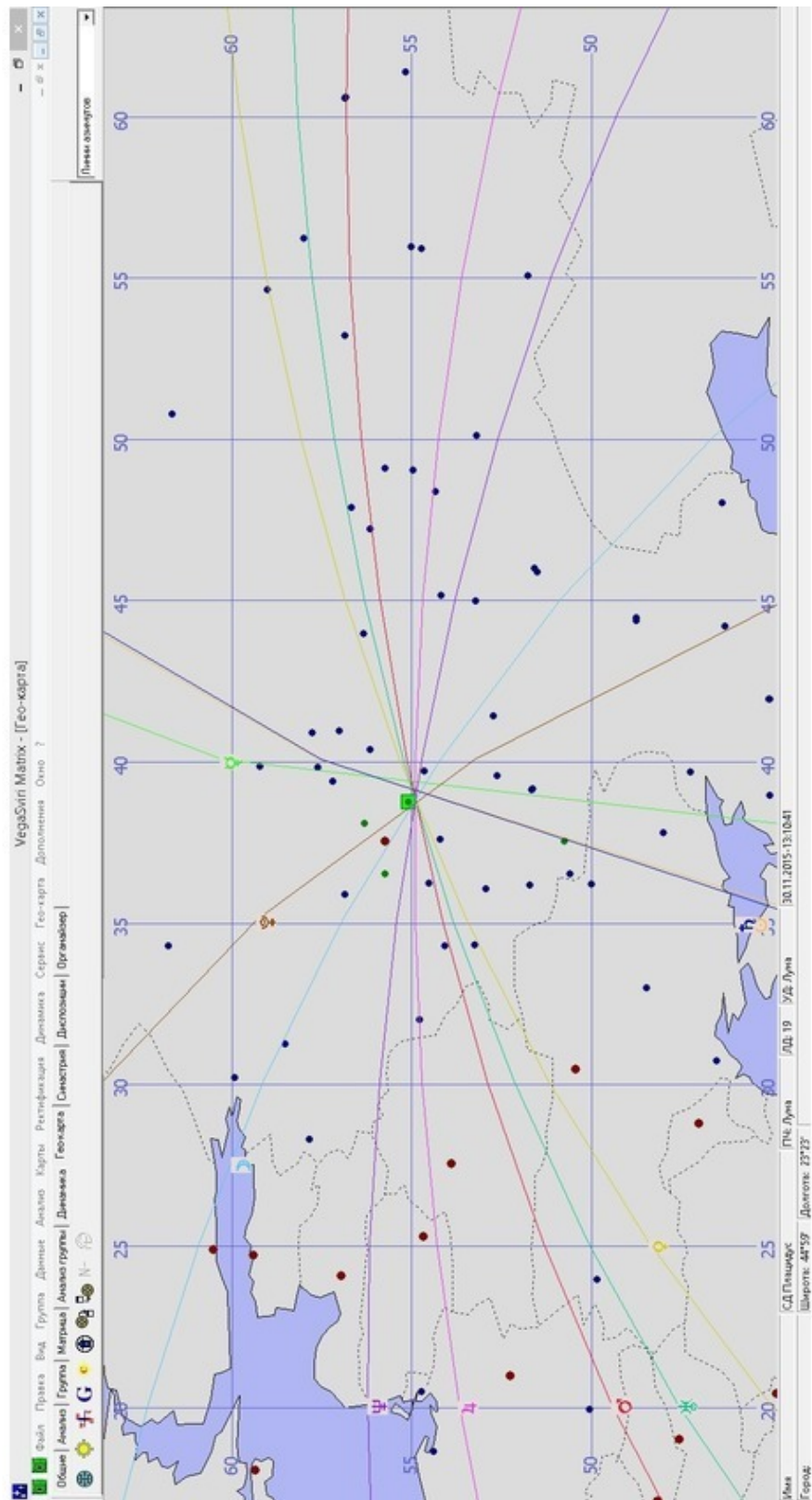

Pic.3. LS on some Earth's region. Astrological program «VegaSviri Matrix»

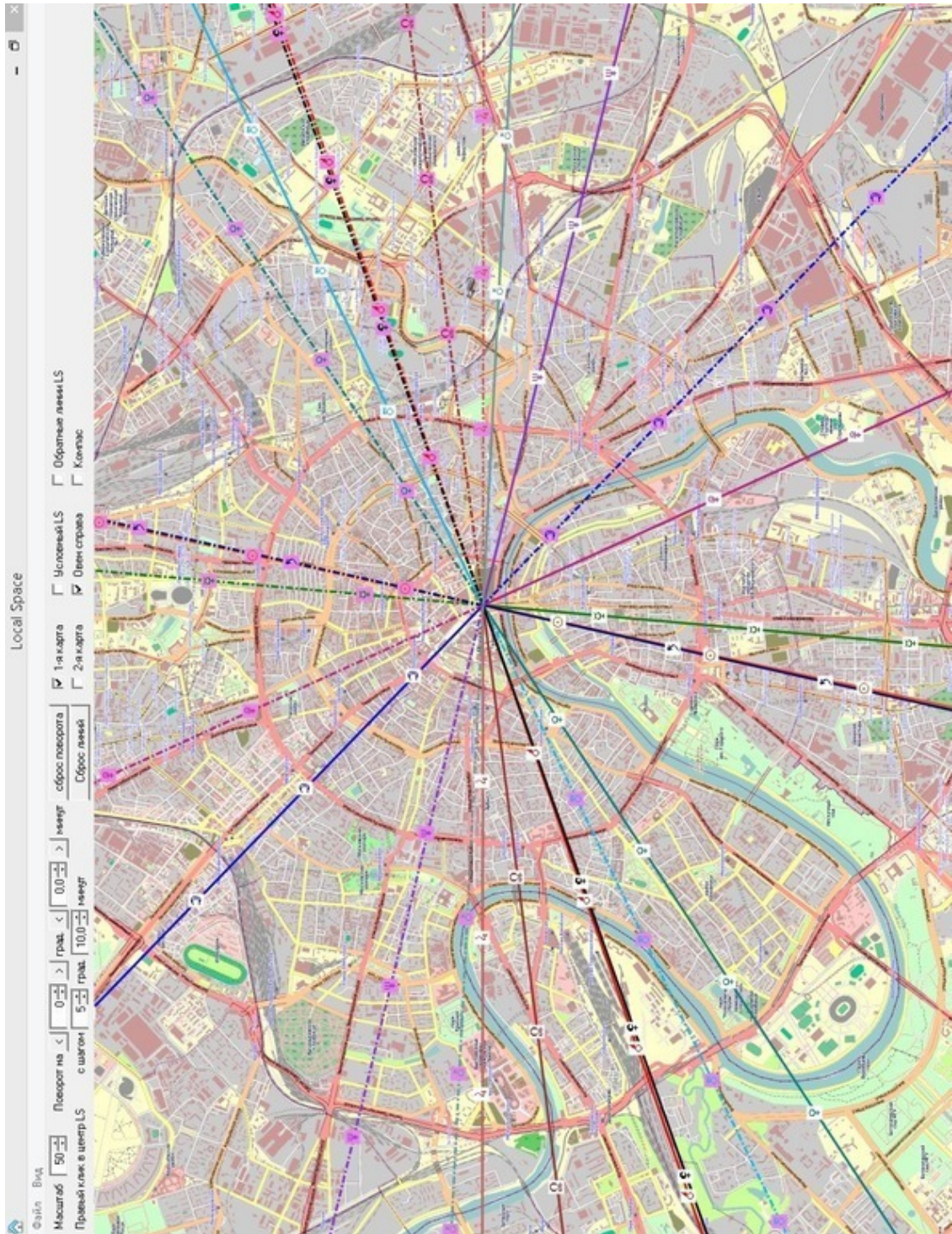

Pic.4. LS on Moscow city. Astrological program «Astrogeography v2.7.»

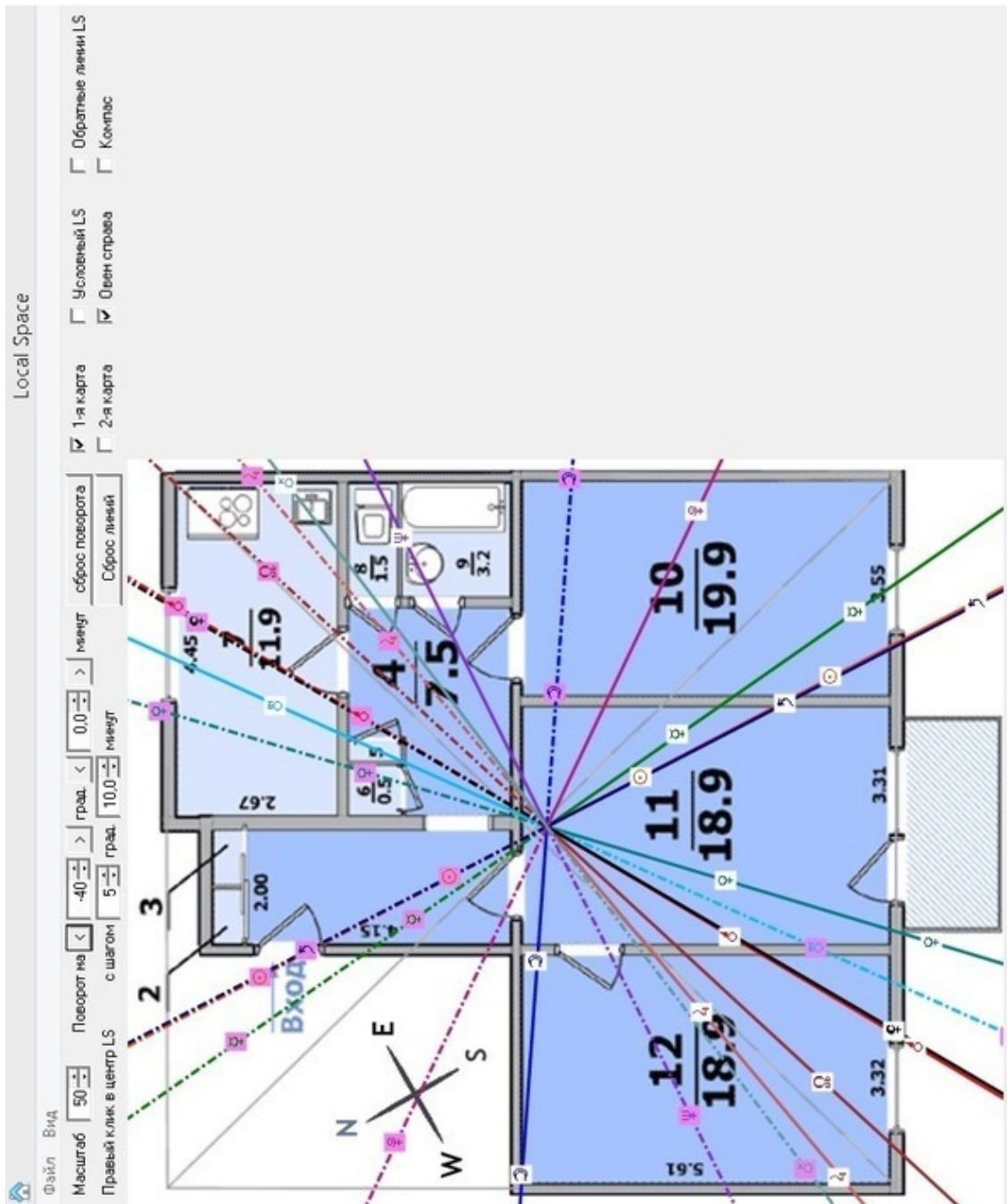

Pic.5. LS on flat's design. Astrological program «Astrogeography v2.7.»

Descriptions of planetary lines of Is

(Description from the program «VegaSviri Matrix»)

Moon

When locating on Moon line, you feel at home, enhance the perception of soul. Here, you easily escape from the works, feel free, and you can be emotionally open, and sensitive. It is the successive line for the residence and family vacation. On this line, the mother nature will reveal itself very clearly, as well as your way of relations with her. For women – indication on the potential maternity.

Mercury

Locating on Mercury line, you strengthen your set of mind. Here you can make successful acquaintance, socialize, study, work with various information, analyze. It is the assignment for business trips, development of trade relations, learning of foreign language, study and traveling. On this line actualizes the subject of blood relations.

Venus

Locating on Venus line, you raise the significance of partnership relations. This line is favorable for romantic relations, search of the marital or business partner. Here, you extremely show yourself, as charming and attractive person. It is the fortunate location for earnings, self-fulfillment in social life and enhancement of ethical and aesthetical principles.

Sun

Locating on Sun line, you intensify your will, ego and natural spirit. You will easily make important decisions or solve notional tasks in the right direction. Besides, this line favors in realization of creative personality. You can reveal all kinds of talents. Here will be evaluated your executive talent, your skill to manage, to spirit, to invigorate and undertake trailblazing projects. On this line, the father nature will reveal itself very clearly, as well as your way of relations with him. For men – indication on the potential paternity.

Mars

Locating on Mars line, you intensify your activity, impulsion, impetuosity and commitment to result. It is work area, area of self-activity. Here are revealed the best man features, for the women – the growth of attraction of the sterner sex. At once – it is the line of enhance of the conflict.

Jupiter

Locating on Jupiter line, you increase your opportunities. It is the successful direction for broadening of outlook, finding sponsors and protectors, acquiring of new knowledge, obtaining a higher education, taking a degree, expansion of your influence. Here you can start new promising business, meet business partners, make successful investments. In general – it is the line of success.

Saturn

Locating on Saturn line, you intensify your internal concentration, self-discipline and asceticism. This line is favorable for slow, but true career progression. Otherwise, it assumes obstacles, limitations, restrictive circumstances. Probable depression and breakaway phenomenon.

Uranus

Locating on Uranus line, you intensify eccentricity, adventurism and temper distinction, raise the probability of extreme situations, nervous strain. The line might be successful for search of friends, confederates, for reformatory and revolutionary activities, for learning of information and computer technologies, astrology activity and research studies. Favorable direction for extreme vacation.

Neptune

Locating on Neptune line, you enhance your undersense. Here you can have good vacation, dream, and meditate. This line will show where you can go for religious pilgrimage. This line offers you great illusions, inspiration and opportunity to become a poet, painter or musician. Favorable

direction for sea voyage, for underwater survey, for fishing. Probably, the growth of attraction and finding of a great love.

Pluto

Locating on Pluto line, you raise the fatality of your fate. Here you will face fatal circumstances, which will give you the supreme transformation. The line is successful for sexual self-fulfillment. If you have energy and resources to walk at the tip of the spear, it is good direction for traveling to «flash points», to volcanoes or for underwater and caves survey. In other cases – unfavorable direction.

It is important!

You should pay attention on: – Midpoints of planetary lines. Status of the planets in horoscope. – Definition of actual center of the city. – Peculiarities of work in transpolar latitudes.

Samples of ls

Sample 1

Native had worked on Jupiter line. The things were going good. On this line, he had had good authority, he had been followed by good luck and success, he had been full of optimism and great plans. He had had good health.

After a while, he changed his job, moved to Pluto line. The work started to bring stress and great emotional upheaval. Due to the long state in condition of extra stress, he started to suffer from various deceases and phobias.

Sample 2

The native in his horoscope has Moon in debilitated position in the 3rd House, which is almuten of VII and VIII houses of horoscope. During his life he got himself into a mess for three times (money loses).

The first time he was deceived on a large amount in the exchange office.

The second time, he was ineffectually consulted by another astrologist at a high price.

The third time, he had failed rent payment of the trading place.

All events took place in different locations of the same city, but all three events took place on the same line of Moon's azimuth.

Sample 3

Native had been involved in shoot-out where he was knifed. While drawing LS and putting it on city map, the place setting was not displayed by the planets. However, during detailed review, it turned up, that event took place precisely on Midpoint line of Mars-Pluto.

Astrogeography

Technical calculation

Astrogeography (hereinafter – AGG)

The local charts (local horoscopes) are drawn at the time of birth and at all possible places of birth of the native on Earth.

Junctions of the same planets with the same houses cusp are drawing with continuous lines.

There are two variants of calculation and drawing of these planetary lines:

Only junctions of planets with horizontal (ASC – DSC) and vertical axes are used. The projection of the planets is made on EQUATOR (with account of latitude and inclination of the planet):



Pic. 6. Projection of AGG – lines on Equator. Setting up. Astrological program «VegaSviri Matrix».

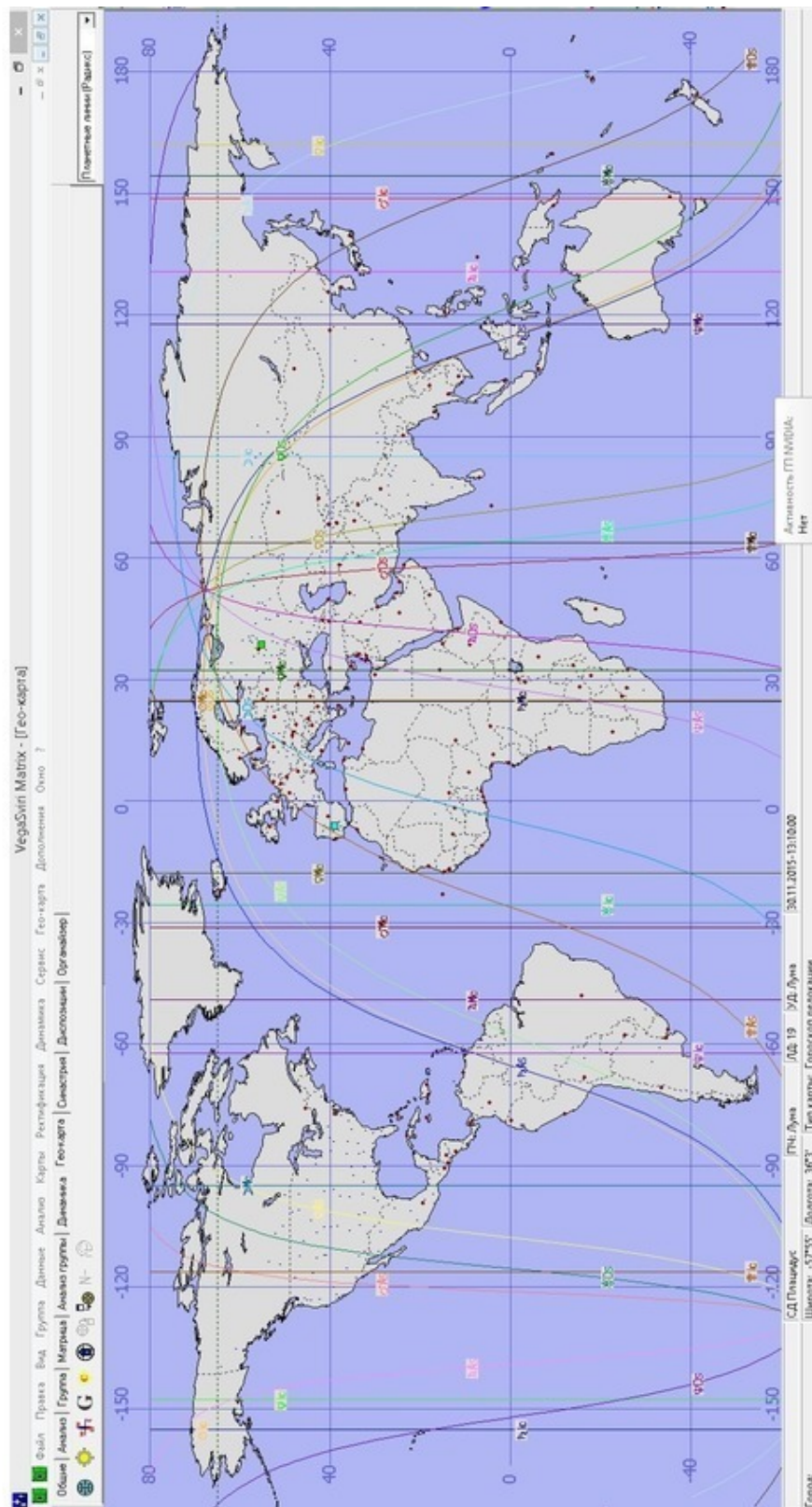

Pic. 7. Projection of AGG – lines on Equator. Layout. Astrological program «VegaSviri Matrix»

.Only junctions of planets with all 12 houses cusp of horoscope are used. The projection of the planets is made on ECLIPTIC (excluding the latitude and inclination of the planet).

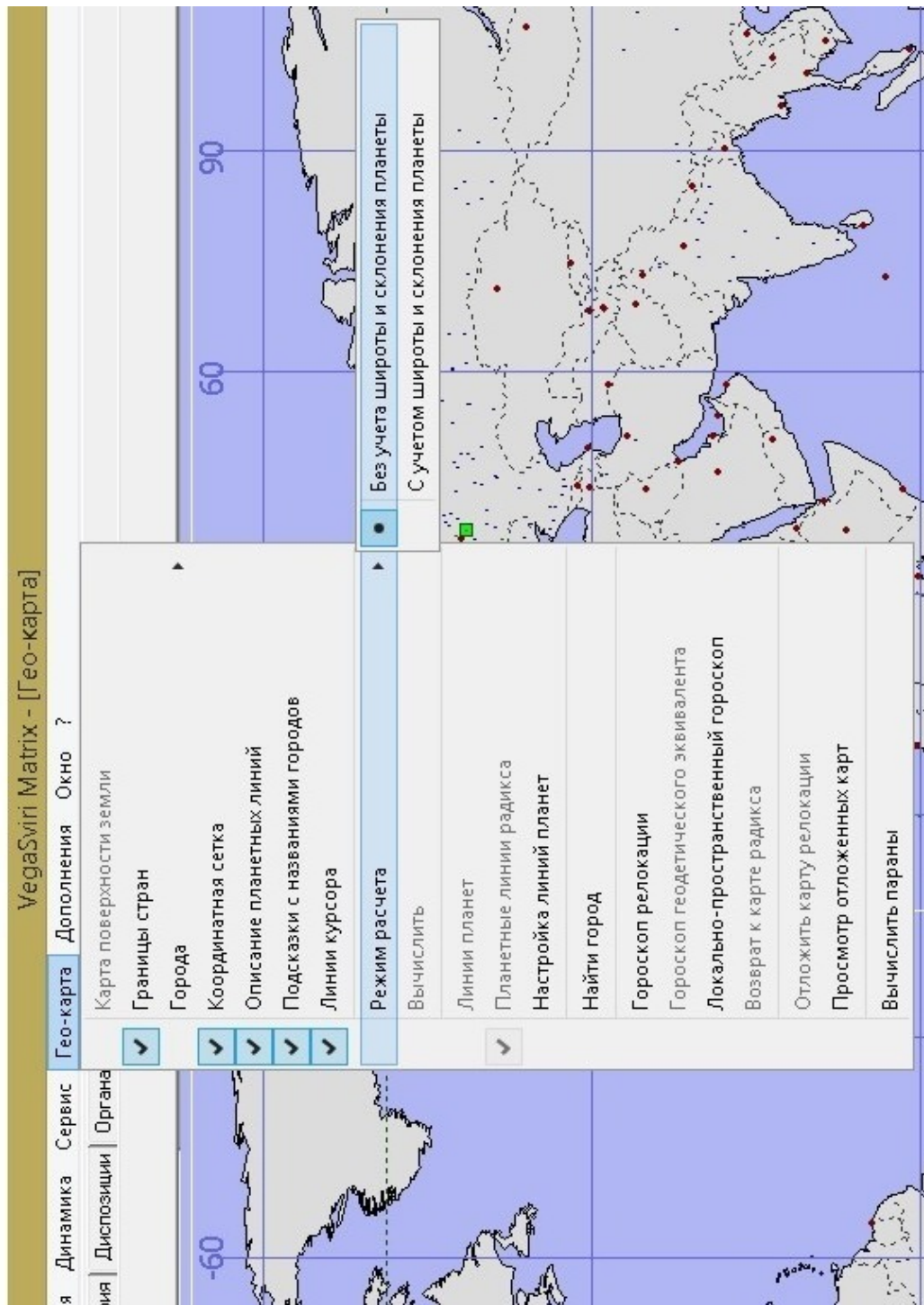

Pic. 8. Projection of AGG – lines on Ecliptic. Setting up. Astrological program «VegaSviri Matrix».

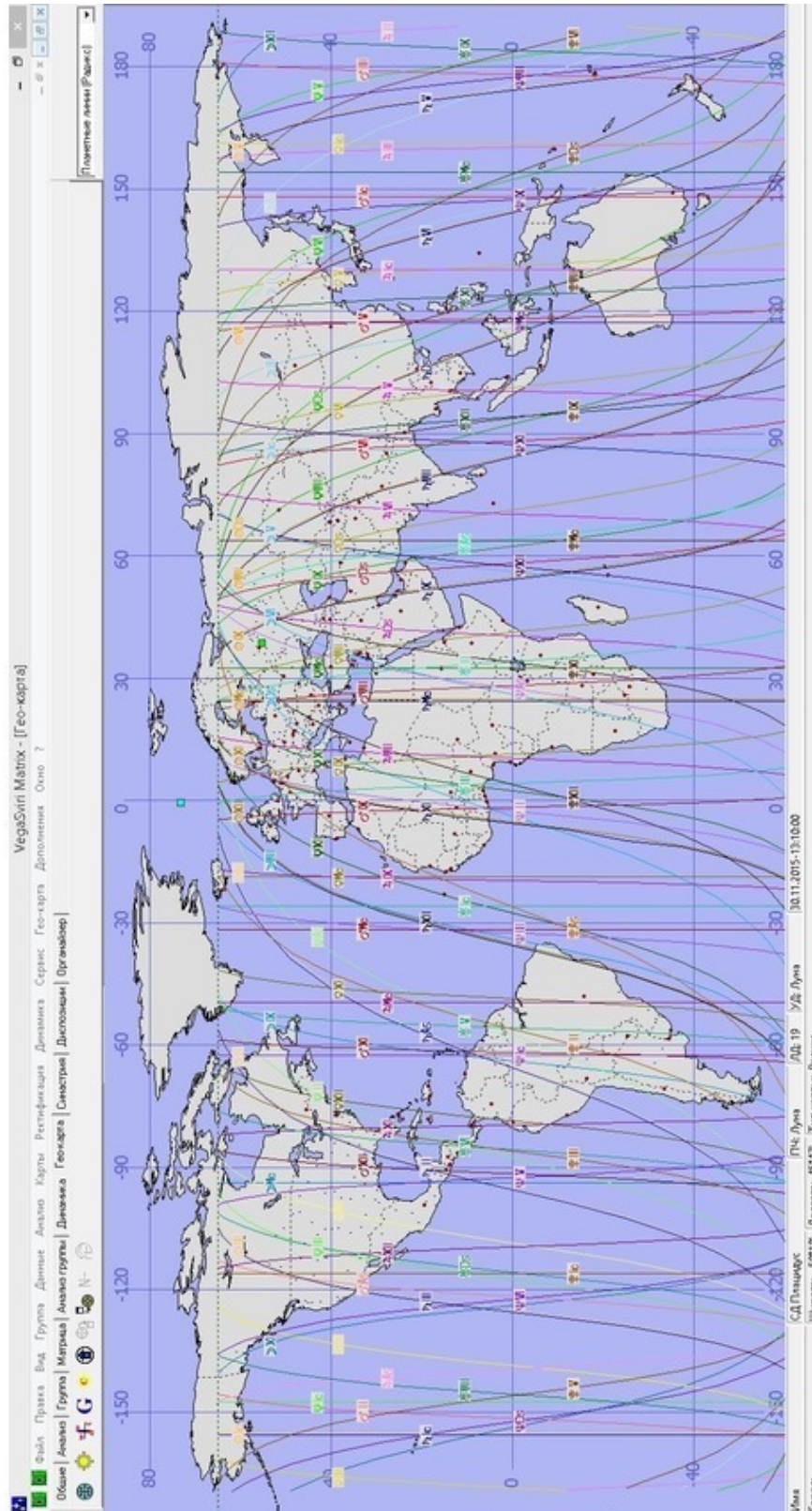

Pic. 9. Projection of AGG – lines on Ecliptic. Layout. Astrological program «VegaSviri Matrix».

What is the difference? As my practice shows, eventually, the more readable is the first variant, with projection of the planets on EQUATOR. As well, the junction of the planets, with the main

axes of the horoscope, shows the most important and significantly fateful planetary aspects in one Earth's location or another.

Moreover, while comparing both variants, we reveal the significant differences for the planets: Moon (to 10 degrees) and Pluto (to 20 degrees), which in case with the latter is the outstanding factor.

I use orbis +/- 500km.

Interpretation

If the LS might be assimilated to location of the planets in Signs, I would compare Astrogeography (AGG) with location of the planets in horoscope houses.

That is to say, LS works primarily psychologically and only then eventually. Therefore AGG – primarily eventually and then psychologically.

The radix lines (natal chart) are the fundamental indicator of long-term planetary influence on one place or another. The radix line should be considered for long-term events, for example, while choosing of permanent place of residence.

The planets in the houses of horoscope

The short eventually description of the planetary AGG lines. Projection on Equator:

Moon: Fertility for women;
Mercury: Education, contacts;
Venus: Love, money;
Sun: Fertility for men;
Mars: Conflicts, fires;
Jupiter: Authority, popularity;
Saturn: Restrictions, obstacles;
Uranus: Instability, changes;
Neptune: Religiosity, complexity;
Pluto: Crises.

In junction with angles of horoscope, we read them as follows:

ASC: personal initiative;
IC: home, family, ancestors;
DSC: initiative of the partner;
MC: Initiative from the State, Chief.

More detailed description of planetary AGG lines.

Projection on Ecliptic.

Astrological program «VegaSviri Matrix».

Moon

Moon in the I house

of the horoscope forms a range of events on subject, such as care, patriotism, study of the family tree, it is one of the best locations to solve the problems of childlessness and impregnation. Life events in this location activate in native emotional, sensitive, sentimental, flighty, vulnerable psyche. The outward form tends to round shapes. The gastronomical predilections and dainty appetite are rankled. Emotions are visible. Everyone can see the mood of native. On this territory, the resonance of horoscope is intensified. It is important for the native to know the people's opinion. Childish complexes and injuries become visible. Childish rueful feelings and family problems influence greatly on your self-concept.

Location for impregnation of women on personal initiative.

Moon in the II house

of horoscope models form a range of events on subject of accumulation of resources of the Moon subject. You are in heavy want of material benefits and you are attached to things and property. You keep hold of acquired values and try to keep them in the family. You keep the household gods, which remain you about past events and mainly define the style of your communication with people at present moment. You are parsimonious and assiduous person, nevertheless your financial condition leaves something to be desired. It is all the fault of unstable source of income and necessity to provide the financial support to the members of your family.

Moon in the III house

You are curious, active, psychologically penetrating, you like to fantasize. Your acquisitive mind is always ready to accept new information. Even while eating, you can not dispense with newspapers or TV. The humdrum is boring you. Only trips, social life, study let you feel yourself comfortable, you get food for reflection and actions. It may happen, that in your childhood you changed the schools, however it turns for the better. Brothers and sisters (if you have any) always disturbed you. Nevertheless, you are very devoted to them on emotional level.

Moon in the IV house

The main your concerns – home, family, family traditions. Without them, your life loses its meaning, you want to bury your face in the sand, hide in your own world. It is surprising, but with this location of the Moon, you might be attached greatly to your house, household, people close to your heart and at the same time you can not create for them friendliness of the environment in the family. The disadvantages of others are very irritating, so you consider your family the main reason of your misfortunes and sorrows. The habits and codes of conduct, acquired in your childhood, are preserving for the term of your life, and with aging, they will develop more intensively. While changing your flat, you keep attached to your previous residence. Probably, after lingering searches and wanderings, at the end you will back to the place, where you have spent your childhood and youth.

Moon in the V house

turns you into an open and credulous person, unable to hide your true responses on situations and behavior of people. You do not make secrets about your personal likes and dislikes. You are romantic, emotional, with good artistic imagination, you are bent to love adventures, intrigues and search of pleasures. Your likes frequently change, and recent idol turns out different, as you had imagined him before. You love children very much, this devotion makes good tutors of the men and

because of them women sacrifice their careers. For vacation, you need to go in for sport, games and entertainments. If you want to make a holiday for yourself, it will be noisy.

Moon in the VI house

characterizes you as pragmatic and hardworking person. You are strongly convinced, that concern should be expressed in particular, meaningful actions. Sympathy in words – is not your ideal. You are always ready to help those, who need it, you will never ignore the work problems of your colleagues, and to the contrary, you will actively participate in their fate. Fastidious to yourself, sometimes you are too judgmental to your environment, you make no distinctions between Chief and subordinate. Emotions greatly influence on your relations with management and colleagues, so you have to change your job more often than you want. In any case, your desire to benefit makes you a good professional in chosen occupation. Your blind side – health instability, probably it is because of chronic illness, that you have had in your childhood. Eutrophy and dieting are very important for you.

Moon in the VII house

shows you as a person, who is badly in need of emotional support from another people. You should always be surrounded by your relatives and friends, and try to have good relations with them. Without a significant other, whom you can lean on, you feel uncomfortable. Further, the fate attracts to you sensitive people with frequent change of heart, bent to trips, involved in public work, who like a variety. Many of them are unreliable, but sometimes you do not have choice, as the loneliness is more frightful for you. The devotion to marital partner might be for you the obstacle to happy marriage. You bent to be too guardian to the people you love.

Moon in the VIII house

characterizes you as an autocrat, who likes to manage and sometimes manipulate. From those, whom you love, you expect all or none, without any middle. More than likely, you inherited these traits from mother or grandmother, who play a big part in your life. Strict and autocrat, usually she rules the house, she is always interfering and controls all behavior of household. It leads to the furious conflicts, until you decide to be entirely independent person. The interest to psychology, psychic powers, sensibility to invisible forces will help you. You have an ability to develop occult powers for the practical use. Financial well-being will come with marriage and partner.

Moon in the IX house

shows you as teacher, tutor, educator. There is high probability, that in the green years, you will travel a lot or you will spend a lot of time on studying of the other culture, philosophy, history and religion. You unconsciously aspire to those things, which are far away from you, remote countries, to something unexplored. It is very important for you to get good education and have respective environment. Your philosophy is based on your own ideals and social-ethic values, your convictions are rather emotional, than competent. You tend to advertising and publishing activities, juridical disciplines and study deep layers of social relations.

Moon in the X house

characterizes you as a person, who directs to high social and employment status, practical ascendancy over the people. You have great need in authority and honor. To achieve it, you need to change your profession or job place several times. Most of all, you are attractive to work with public at large, with people. People accept and understand you, particularly the women. Your social status is unlikely to be stable, as your career depends heavily on mood of environment and policy state. Ambition and aspiration for power show itself strong in you, if your parents had a high position

and from your childhood, they inculcated you a sense of your own exclusiveness. It may happen, that they, particularly your mother, predetermined you career choice. Your career depends heavily on women and it will be successful when you will work with female staff. Your work might be concerned with charity and social funds.

Moon in the XI house

says of your heavy need in friendship and team work. You are easily make acquaintances, but also you easy break them off. In your relations with people, there is always a risk to choice the wrong friends or to be dependent on them. You have good organizational skills, you do not have any prejudices. You are objective and impartial, but you often change your interests in accordance with opinion of your friends. Among your friends might be big and even famous people, who promote your vogue and public acceptance. You realize your communication need through participation in work of various organizations and club activity. Your real family – are not your relatives, but friends, who have the same view with you and whose opinion you consider, when accepting important decisions.

Moon in the XII house

shows you, as a shy and too sensitive person. You feel uneasily and uncomfortably in unfamiliar place, among strangers, you often bury your face in the sand in the world of your mysteries and fantasies. Your feelings and emotions are the mystery for you; moreover, it is difficult to explain them to others. From there your mysteries and omissions emerge. You have embittered relations with mother and other female relatives. At the same time, you understand very well the dejected, offended and suffering people and often, you help them with pure altruism.

Конец ознакомительного фрагмента.

Текст предоставлен ООО «ЛитРес».

Прочитайте эту книгу целиком, [купив полную легальную версию](#) на ЛитРес.

Безопасно оплатить книгу можно банковской картой Visa, MasterCard, Maestro, со счета мобильного телефона, с платежного терминала, в салоне МТС или Связной, через PayPal, WebMoney, Яндекс.Деньги, QIWI Кошелек, бонусными картами или другим удобным Вам способом.